

FLUSH HOLLOW METAL DOOR

Heavy-duty steel door for commercial, industrial and institutional applications

Our stock hollow metal door is an affordable non-handed, square-edge door solution designed to meet your requirements for quality full flush steel doors - for commercial, institutional and industrial applications. Stocked with Steelcraft locations, these doors are designed to satisfy your requirements for durability, security, aesthetics or fire protection. Trudoor is authorized by Warnock Hersey / Intertek to modify, re-certify and label fire-rated metal doors.

Features:

- Heavy-duty, SDI Level 2 - 18 gauge steel faces
- 1-3/4" Thick, non-handed design with reversible hinge plates
- Polystyrene or rigid honeycomb core
- Inverted top and bottom channels for additional stability and protection
- Interlocking seam enhances structural rigidity and durability
- Heavy gauge hinge reinforcements and door closer reinforcement
- Available with a wide range of glass lites, louvers and hardware preps
- Factory applied rust inhibiting primer (no special color options)
- Fire-rated up to 3 hours with WHI / ITS mylar label applied
- Preps include 161 (cylindrical lock), 86ED (mortise lock), RPD (Rim Panic Reinforced)



Code Compliance:

- Meets or exceeds ANSI A250.6 and A250.8
- Construction meets the requirements of ANSI A250.8
- Listed for installations requiring compliance to negative pressure testing (UL-10B) and positive pressure (UL-10C)
- Florida Product Approved

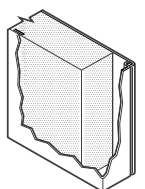
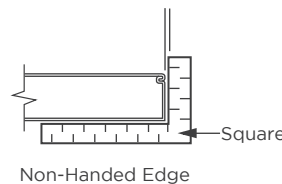

Polystyrene Core

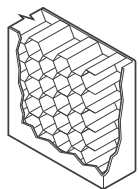

Honeycomb Core

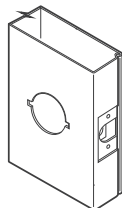

161 Lock

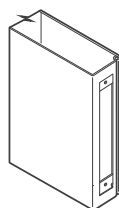

86ED Lock

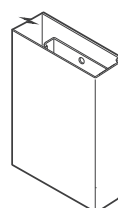

RPD

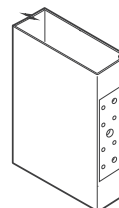

Non-Handed Mortise Hinge Prep



Grade and Model:

ANSI A250.8 - SDI 100			Edge Construction	Maximum Sizes		Recommended Gauge of Frame
Level	Model	Description		Single	Pair	
Level 2: Heavy Duty Commercial			18 gauge (1.0 mm) - heavy commercial and institutional applications with high use			
2	1	Full Flush	Visible	4'0" x 8'0"	8'0" x 8'0"	16 gauge (1.3 mm)

Grades and models defined by Steel Door Institute (SDI)

Manufacturers include Steelcraft and ASSA Abloy