

**CLASSIC FRAME (S-Series & C-Series) - PAIR**

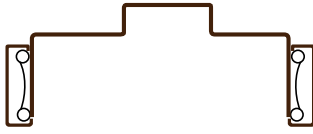

Shown with TA-8 Steel Casing as example.

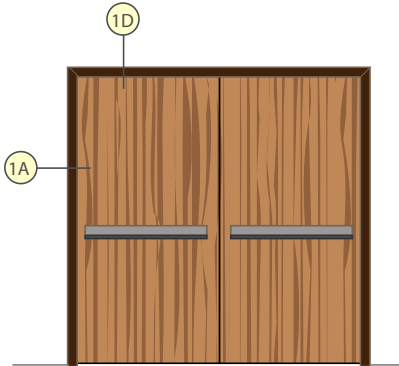

Classic Frame - **PAIR**

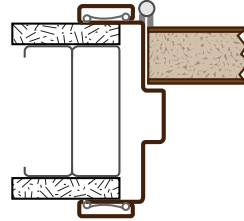

1A

Jamb Hinge Side

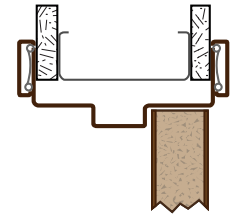

1D

Header

**CLASSIC FRAME (S-Series & C-Series) - PAIR**

**RELATED INFORMATION**

**SOUND**

FRAME MATERIALS	DOOR SIZE AND WEIGHT	JAMB DEPTH RANGES	RATINGS
Prefinished Steel	<p><b>Door Thickness:</b> 1 3/8" or 1 3/4"</p> <p><b>Max. Door Weight:</b> 250 Lbs. each</p> <p><b>Max. Door Width:</b> 2 x 4' - 0"</p> <p><b>Max. Door Height:</b> 12' - 0" *</p>	<p><b>Standard Jamb Depths</b></p> <p><b>S-Series (20 gauge):</b> 2 5/8", 2 7/8", 3 3/4", 4 5/8", 4 7/8", 5" and 5 3/8"</p> <p><b>C-Series (18 gauge):</b> 2 5/8", 2 7/8", 3 1/2", 3 3/4", 4", 4 5/8", 4 7/8", 5", 5 3/8", 6 5/8", 6 7/8" and 7 1/4"</p> <p><b>Custom Jamb Depths</b></p> <p><b>C-Series (18 gauge):</b> 2 5/8" to 13" in 1/8" increments.</p>	Not Available

\* Height on custom Jamb Depths is limited to 10' - 1"

All widths and heights are inside dimensions - net door or glass opening size.

**CLASSIC FRAME (S-Series & C-Series) - PAIR**

**FIRE RATING**

JAMB DEPTH RANGE	45, 90 minute (S & C-Series)	GENERAL INFORMATION
<p><b>Min. Jamb Depth:</b> 3 3/8"</p> <p><b>Max. Jamb Depth:</b> 13"</p>	<p><b>Max. Width:</b> up to 6'</p> <p><b>Max. Height:</b> 9' - 0"</p> <p><b>Max. Width:</b> over 6' up to 8'</p> <p><b>Max. Height:</b> 8' - 0"</p>	<ol style="list-style-type: none"> <li>All openings approved for Positive and Neutral pressure unless otherwise noted.</li> <li>All ratings apply to steel stud, wood stud, or masonry construction.</li> <li>All ratings approved for category "A" and "B" doors with category "G" edge sealing.</li> <li>Timely's fire rated <i>Metal "U" Insert</i> is recommended for masonry installations. If wood subframe is used in place of <i>Metal "U" Insert</i>, it will be necessary to use fire rated drywall on both sides of wood to maintain fire rating.</li> <li>Wood, Aluminum or PVC casing does not affect ratings on door frames. Wood casing must be applied with hot melt glue or contact adhesive on 90 minute rated frames and on all glazed openings with 45 minute or 60 minute rating. On all other fire rated frames, wood casing can be applied with nails or finish head screws on jambs and mullions.</li> <li>Embossed WHI 90 min. label is available for Primer Galvanized Frames only.</li> <li>Metal 90 min. label riveted to frame is available.</li> </ol>

All dimensions shown are inside dimensions - net door opening size.

Distributors of Timely Frames may be approved to purchase labels and apply them to frames at their own facility. Intertek has set guidelines and a fee schedule for this program. Requirements and prices are available from Timely or Intertek.

## CLASSIC FRAME (S-Series & C-Series) - PAIR

### ROUGH OPENING DIMENSIONS

#### WIDTH

For a pair of doors, the rough opening width is 1 1/4" larger than the total nominal width of the doors plus the width of any astragal mounted between the doors.

Width is sum of the nominal width of both doors leaves plus the astragal if it is mounted between the doors

**ROUGH OPENING:** Nominal Door width(s) + astragal width (if mounted between the doors) + 1 1/4"

#### HEIGHT

For a pair of doors, the rough opening height is 1" over nominal height or 13/16" over net height. Since Timely standard frames are actually 3/16" longer than the nominal height (Timely 7'0" frames are actually 7'0 3/16" long).

Height is the inside dimension of the frame

**ROUGH OPENING:** Net door height plus 13/16

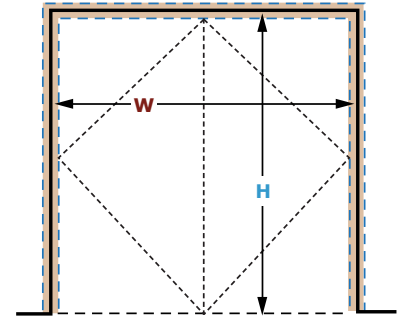

**W** = Nominal Door width(s) + Astragal + 1 1/4"

**H** = Nominal door height plus 1"  
Net door height plus 13/16