

**CLASSIC FRAME (S-Series and C-Series) Sidelight(s)**

Shown with TA-8 Steel Casing as example.

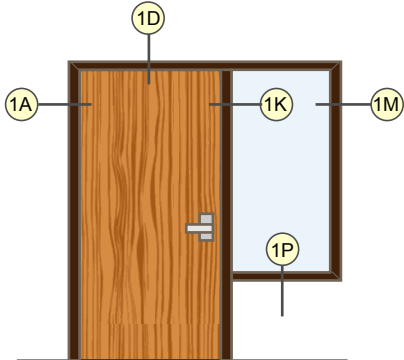

Classic Frame - SINGLE with Sidelight Partial Height

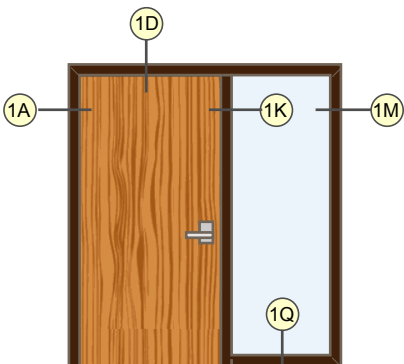

Classic Frame - SINGLE with Sidelight Full Height

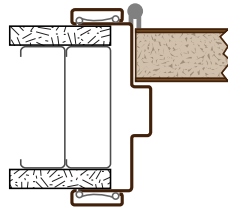

1A Jamb Hinge Side

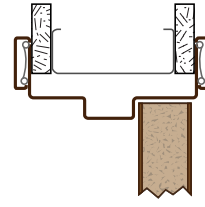

1D Header

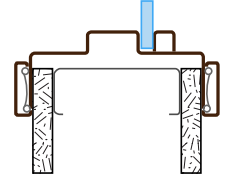

1P Sill Glazing

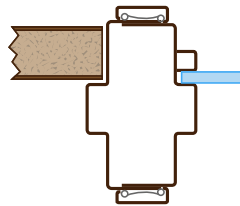

1K Mullion - Strike Side

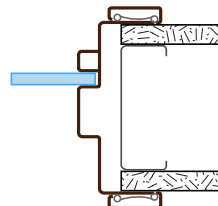

1M Jamb Glazing

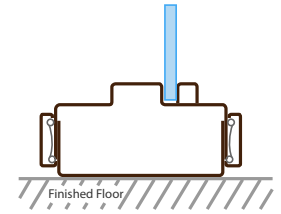

1Q Sill Glazing Flush

**ROUGH OPENING DIMENSIONS**

**WIDTH**

Opening width area will vary if using a partial height or stepped sidelight. The opening dimension is calculated separately for each "step" in the sidelight.

**ROUGH OPENING WIDTH W1:** Total of the Nominal Door Width(s) plus 1 1/4"

**ROUGH OPENING WIDTH W2:** Total of the Nominal Door Width(s) plus the total Net Glass Width(s) plus 2" for each Vertical Mullion plus 1 1/4"

**HEIGHT**

Opening height equals the net door height. For frames with stepped or partial height sidelights, the light area height is calculated differently than the door area. Measurement is based on calculating the rough opening for the door area first, then measuring from the top down on the sidelight area.

**ROUGH OPENING HEIGHT H1:** Net Door Opening Height (H) plus 13/16"

**ROUGH OPENING HEIGHT H1:** Net Glass Height(s) (H) + 2" for each Horizontal Mullion + 1 1/4"

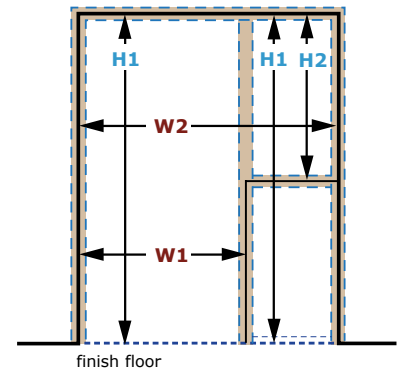

**W1** = Nominal Door Width(s) + 1 1/4"

**W2** = Nominal Door Width + Net Glass Width(s) + 2" for each Mullion + 1 1/4"

**H1** = Net Door Opening Height + 13/16"

**H2** = Net Glass Height(s) + 2" for each horizontal Mullion + 1 1/4"

**CLASSIC FRAME (S-Series and C-Series) Sidelight(s)**

**RELATED INFORMATION**

**SOUND**

FRAME MATERIALS	DOOR SIZE AND WEIGHT	JAMB DEPTH RANGES	RATINGS
Pre-Finished Steel	<b>Door Thickness:</b> 1 3/8" or 1 3/4"  <b>Max. Door Weight:</b> 500 lbs.  <b>Max. Door Width:</b> 4' - 0"  <b>Max. Door Height:</b> 12' - 0" **	<b>Standard Jamb Depths</b> <b>S-Series (20 gauge) ** :</b> 3 3/4", 4 5/8", 4 7/8", 5" and 5 3/8" <b>C-Series (18 gauge):</b> 3 1/2", 3 3/4", 4", 4 5/8", 4 7/8", 5", 5 3/8", 6 5/8", 6 7/8" and 7 1/4"  <b>Custom Jamb Depths</b> <b>C-Series (18 gauge):</b> 3 3/8" to 13" in 1/8" increments.  <b>Max. Mullion Length:</b> 10' - 1"	Not Available
MAX ASSEMBLY SIZE			
<b>Max. Assembly Width:</b> 12' - 0" * (for Standard Jamb Depths) 10' - 1" * (for Custom Jamb Depths)  <b>Max. Assembly Height:</b> 10' - 1"			

\* Wider assemblies will have splice joints in frame and casing.  
 \*\* Mullions are always supplied in 18 gauge.

All widths and heights are inside dimensions - net door or glass opening size.

**FIRE RATING 45 MINUTE**

ASSEMBLY	DOOR AREA	GLASS AREA*	GENERAL INFORMATION
<b>Max. Width:</b> 9' - 7"  <b>Max. Height:</b> 9' - 11"	<b>Max. Door Width:</b> 4' - 0"  <b>Max. Door Height:</b> 9' - 0"	<b>Width:</b> up to 2'  <b>Max. Height:</b> 8' - 11"  Visible light is 1" less in width and height  <b>Width:</b> over 2' up to 3' **  <b>Max. Height:</b> 4' - 6' **	<ol style="list-style-type: none"> <li>All openings are approved for Positive and Neutral pressure unless otherwise noted.</li> <li>All ratings apply to steel stud, wood stud, or masonry construction.</li> <li>All ratings approved for category "A" and "B" doors with category "G" edge sealing.</li> <li>Timely's fire rated <i>Metal "U" Insert</i> is recommended for masonry installations. If wood subframe is used in place of <i>Metal "U" Insert</i>, it will be necessary to use fire rated drywall on both sides of wood to maintain fire rating.</li> <li>Aluminum or PVC casing does not affect fire rating. Wood casing must be applied with hot melt glue or contact adhesive on 90 minute rated frames and on all glazed openings with 45 minute or 60 minute rating. On all other fire rated frames, wood casing can be applied with nails or finish head screws on jambs and mullions.</li> <li>Single frames must be prepared for strike plate or reinforced with (TA-12) for a rim exit device strike.</li> </ol>
All dimensions shown are inside dimensions - net door opening size.  * Multiple Glass Areas can be created with Mullions. The only limitations are Max. Assembly Width and Height. ** For glass widths exceeding 24" the maximum glass area is 1296 sq. in. unless approved by local AHJ.			
Distributors of Timely Frames may be approved to purchase labels and apply them to frames at their own facility. Intertek has set guidelines and a fee schedule for this program. Requirements and prices are available from Timely or Intertek.			